

Line-Mounting Body, Size SAE 12 / NG 10

Type: 12 Series - 2.5-Way - Dual Design

1 Technical data

Ordering code	Description	Material	Maximum operating pressure	Weight	Port 1	Port 2	Port 3	Port 4
10TA	30344	Aluminum	3000 psi [210 bar]	2.133 lbs [0.97 kg]	SAE-10	SAE-10	SAE-10	SAE-10
10TS	30350	Steel	5000 psi [350 bar]	6.212 lbs [2.82 kg]	SAE-10	SAE-10	SAE-10	SAE-10
12TA	30345	Aluminum	3000 psi [210 bar]	2.026 lbs [0.92 kg]	SAE-12	SAE-12	SAE-12	SAE-12
12TS	30351	Steel	5000 psi [350 bar]	5.900 lbs [2.68 kg]	SAE-12	SAE-12	SAE-12	SAE-12

Available on request for quantities > 100 pieces/year.

06BA	30343	Aluminum	3000 psi [210 bar]	2.174 lbs [0.99 kg]	G 3/4" -14 BSPP	G 3/4" -14 BSPP	G 3/4" -14 BSPP	G 3/4" -14 BSPP
06BS	30349	Steel	5000 psi [350 bar]	6.332 lbs [2.87 kg]	G 3/4" -14 BSPP	G 3/4" -14 BSPP	G 3/4" -14 BSPP	G 3/4" -14 BSPP

2 Dimensions & sectional view

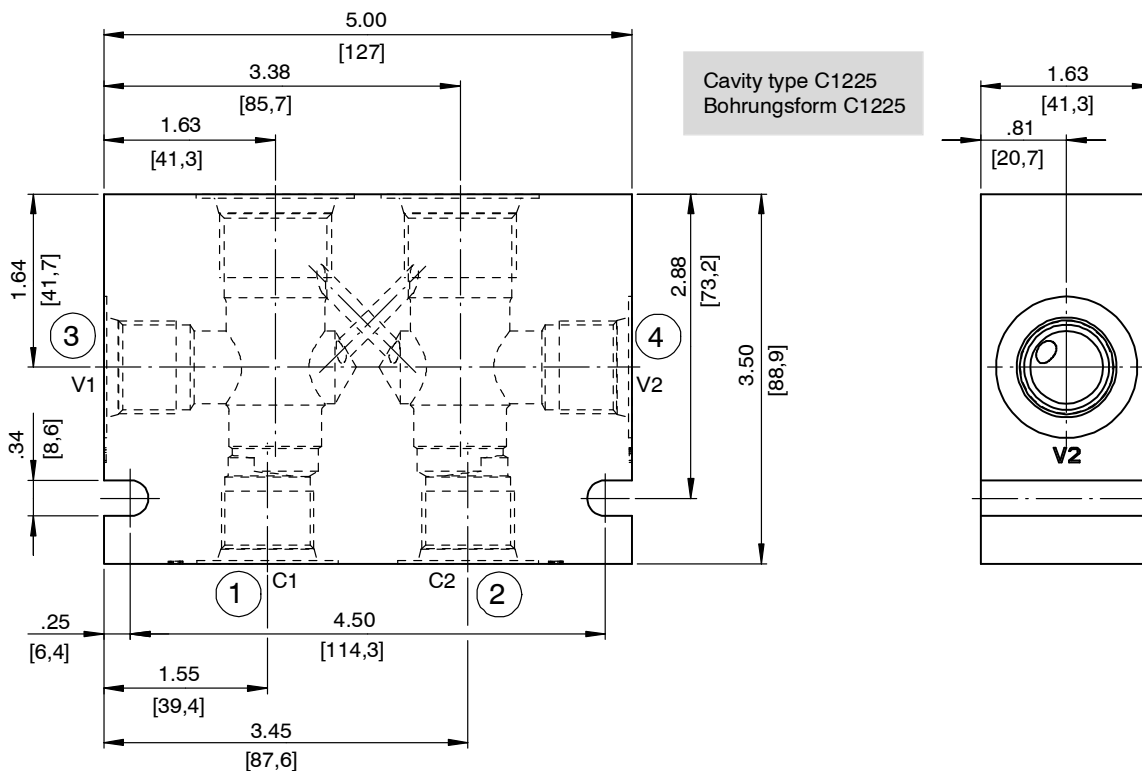

3 Related data sheets

Reference	(Old no.)	Description
520-P-000230	(0-023.0)	Cavity type C1225

info.el@bucherhydraulics.com

www.bucherhydraulics.com/commoncavity

© 2018 by Bucher Hydraulics, Inc., 2545 Northwest Parkway, Elgin, Illinois 60124, USA

All rights reserved.

Data is provided for the purpose of product description only, and must not be construed as warranted characteristics in the legal sense. The information does not relieve users from the duty of conducting their own evaluations and tests. Because the products are subject to continual improvement, we reserve the right to amend the product specifications contained in this catalogue.

Classification: 430.395.-.-.-.