

# Line-Mounting Body, Size SAE 16 / NG 12

Type: 16 Series - 4-Way

## 1 Technical data

Ordering code	Description	Material	Maximum operating pressure	Weight	Port 1	Port 2	Port 3	Port 4
12TA	30220	Aluminum	3000 psi [210 bar]	3.269 lbs [1.48 kg]	SAE-12	SAE-12	SAE-12	SAE-12
12TS	30226	Steel	5000 psi [350 bar]	9.523 lbs [4.32 kg]	SAE-12	SAE-12	SAE-12	SAE-12
16TA	30221	Aluminum	3000 psi [210 bar]	3.084 lbs [1.40 kg]	SAE-16	SAE-16	SAE-16	SAE-16
16TS	30227	Steel	5000 psi [350 bar]	8.984 lbs [4.08 kg]	SAE-16	SAE-16	SAE-16	SAE-16

Available on request for quantities > 100 pieces/year.

06BA	30218	Aluminum	3000 psi [210 bar]	3.306 lbs [1.50 kg]	G 3/4" -14 BSP	G 3/4" -14 BSP	G 3/4" -14 BSP	G 3/4" -14 BSP
06BS	30224	Steel	5000 psi [350 bar]	9.629 lbs [4.37 kg]	G 3/4" -14 BSP	G 3/4" -14 BSP	G 3/4" -14 BSP	G 3/4" -14 BSP
08BA	30219	Aluminum	3000 psi [210 bar]	3.100 lbs [1.41 kg]	G 1" -11 BSP	G 1" -11 BSP	G 1" -11 BSP	G 1" -11 BSP
08BS	30225	Steel	5000 psi [350 bar]	9.029 lbs [4.10 kg]	G 1" -11 BSP	G 1" -11 BSP	G 1" -11 BSP	G 1" -11 BSP

## 2 Dimensions & sectional view

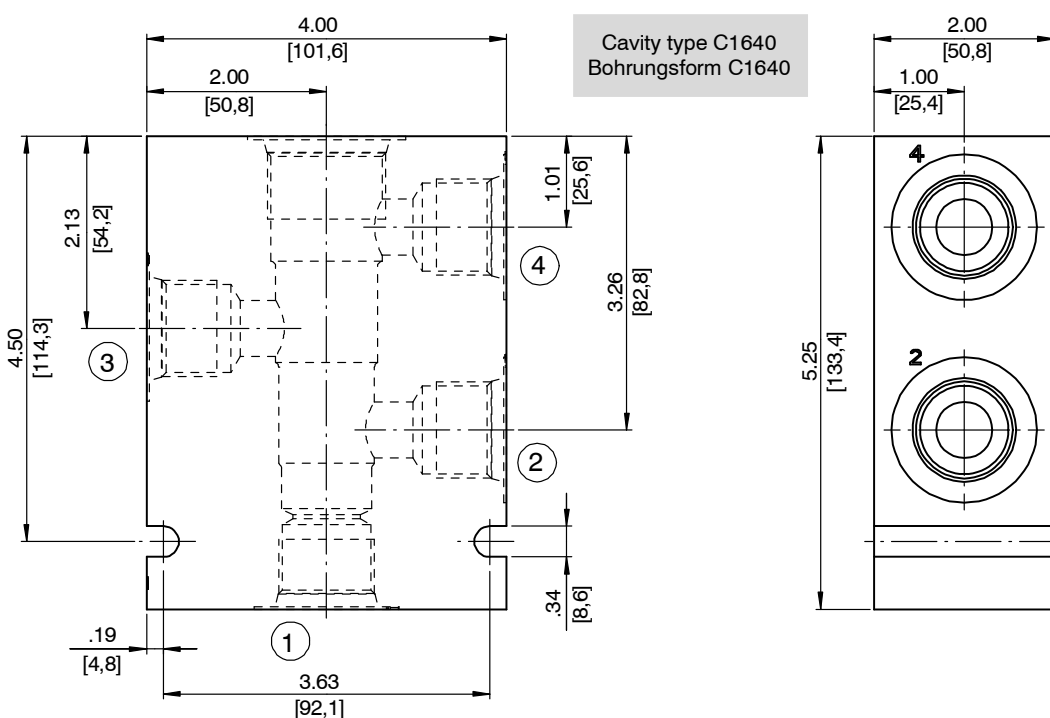

Reference: 520-P-000441-EN-01

### 3 Related data sheets

Reference	(Old no.)	Description
520-P-000440	(0-044.0)	Cavity type C1640

[info.el@bucherhydraulics.com](mailto:info.el@bucherhydraulics.com)

[www.bucherhydraulics.com/commoncavity](http://www.bucherhydraulics.com/commoncavity)

© 2018 by Bucher Hydraulics, Inc., 2545 Northwest Parkway, Elgin, Illinois 60124, USA

All rights reserved.

Data is provided for the purpose of product description only, and must not be construed as warranted characteristics in the legal sense. The information does not relieve users from the duty of conducting their own evaluations and tests. Because the products are subject to continual improvement, we reserve the right to amend the product specifications contained in this catalogue.

Classification: 430.395.-.-.-.