

# Line-Mounting Body, Size SAE 10 / NG 8

Type: 10 Series - 3-Way

## 1 Technical data

Ordering code	Description	Material	Maximum operating pressure	Weight	Port 1	Port 2	Port 3
06TA	30148	Aluminum	3000 psi [210 bar]	0.674 lbs [0.31 kg]	SAE-6	SAE-6	SAE-6
06TS	30154	Steel	5000 psi [350 bar]	1.963 lbs [0.89 kg]	SAE-6	SAE-6	SAE-6
08TA	30149	Aluminum	3000 psi [210 bar]	0.632 lbs [0.29 kg]	SAE-8	SAE-8	SAE-8
08TS	30155	Steel	5000 psi [350 bar]	1.840 lbs [0.83 kg]	SAE-8	SAE-8	SAE-8

Available on request for quantities > 100 pieces/year.

02BA	30146	Aluminum	3000 psi [210 bar]	0.686 lbs [0.31 kg]	G 1/4" -19 BSPP	G 1/4" -19 BSPP	G 1/4" -19 BSPP
02BS	30152	Steel	5000 psi [350 bar]	2.000 lbs [0.91 kg]	G 1/4" -19 BSPP	G 1/4" -19 BSPP	G 1/4" -19 BSPP
03BA	30147	Aluminum	3000 psi [210 bar]	0.661 lbs [0.23 kg]	G 3/8" -19 BSPP	G 3/8" -19 BSPP	G 3/8" -19 BSPP
03BS	30153	Steel	5000 psi [350 bar]	1.927 lbs [0.87 kg]	G 3/8" -19 BSPP	G 3/8" -19 BSPP	G 3/8" -19 BSPP

## 2 Dimensions & sectional view

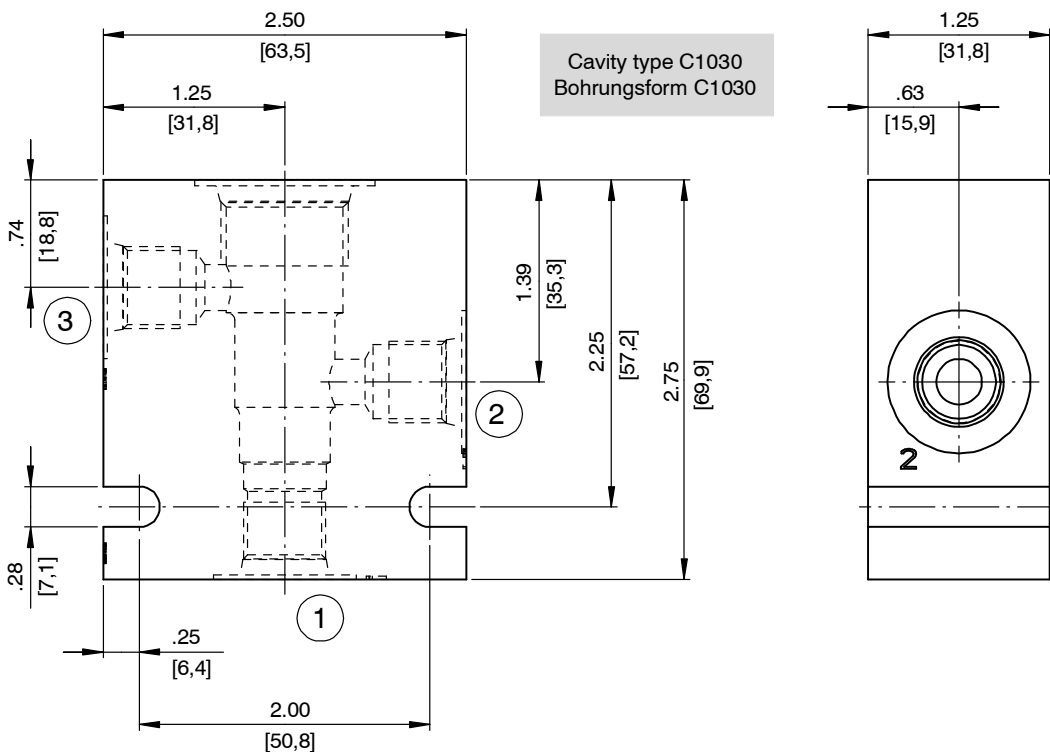

### 3 Related data sheets

Reference	(Old no.)	Description
520-P-000320	(0-032.0)	Cavity type C1030

[info.el@bucherhydraulics.com](mailto:info.el@bucherhydraulics.com)

[www.bucherhydraulics.com/commoncavity](http://www.bucherhydraulics.com/commoncavity)

© 2018 by Bucher Hydraulics, Inc., 2545 Northwest Parkway, Elgin, Illinois 60124, USA

All rights reserved.

Data is provided for the purpose of product description only, and must not be construed as warranted characteristics in the legal sense. The information does not relieve users from the duty of conducting their own evaluations and tests. Because the products are subject to continual improvement, we reserve the right to amend the product specifications contained in this catalogue.

Classification: 430.395.-.-.-.